

KEEP IT

Smart Tracker Tag type Instruction manual



Smart Tracker

Smart Tracker! Press to find the location.
Generates an alarm for disconnection.

Product Characteristics

- Prevent loss of smart phone and valuables.
 - If the smart phone and Smart Tracker falls apart, an alarm will go off on both sides to prevent losses of smart phones and valuables (Wallet, bag, car keys, etc.).
- If you lose your valuables, the tracker will locate it.
 - You can view the last location of the lost valuables on the map in your smart phone app, Smart Tracker.
- Finding smart phones.
 - When the smart phone is close to the Smart Tracker, you can find your smart phone by pressing the Smart Tracker button twice, quickly.
- Finding Valuables.
 - You can find your valuables (Wallet, Bag, Car Keys, etc.) in the smart phone app within a touch.
- Notification of close-up belongings.
 - At the airport baggage claim area, the smart phone will beep when it is close to the belongings.

Product Components

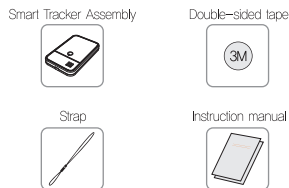

Component Names

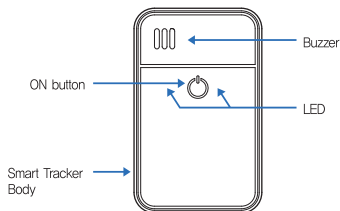

Product Assembling Diagram

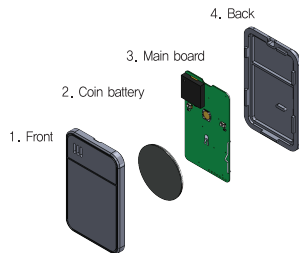

Battery Replacement Method

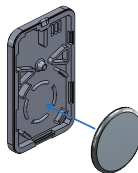

- After removing the front part of the product, remove the used coin battery in the coin battery holder.
- Replace the new coin battery into the battery holder in the same direction (refer to the product assembling diagram), and then assemble back the product.

Product Specifications

Rated voltage	DC3V
Battery	Lithium CR 2016 battery
Communication mode	Bluetooth 4.1
Size	W*D*H 40X25X5.66(mm)
Certification details	KC certification

Cautions

- The Smart Tracker is only a service device that helps in preventing losses. It does not 100% prevent the loss of smart phones and items.
- Due to the nature of Bluetooth, which is being susceptible to frequency bands, smart phones may have a loading issue depending on the user environment.
- This product is not waterproofed, thus if water permeates, it can be a cause for malfunction.
- There can be restrictions depending on the smart phone model when various Bluetooth products are used at the same time.
- Users should not attempt to disassemble, repair, or modify the product by themselves, please contact the customer center. (Warranty will not be applied to disassembled products.)
- Use a rating battery (lithium CR2016).
- Battery consumption may differentiate depending on the user's environments and habits.

Service Center

Homepage www.ehisoft.co.kr

Product Warranty

- This product has been manufactured through strict quality control and technical verification.
- The manufacture warranty period is for 6 months from the date of purchase.
- Repair costs will be charged regarding mechanic failure caused by user's negligence.
- The company will not be responsible for the damages done to the product caused by the user's negligence.
- Since this product is a short-distance wireless communication product for preventing lost, it does not guarantee distant situation.

Model Name	EHITTY01		
Product name	Smart Tracker(Tag type)		
KC authentication number	MSIP-CRM-EHI-TAG01		
Rating	3V		
Identification code	MSIP-CRM-EHI-TAG01		
Date of purchase	year	month	day
Place of purchase			
Guarantee period	Six months from the date of purchase		
Manufacturer/Country	EHI Co.,Ltd. / Korea		
Agent	EHI Co.,Ltd. / Korea		